

MODEL	WW IN [MM]	SPEED FPM [MPM]	ROLL DIA IN [MM]	ROLL WT LB [KG]	A IN [MM]
PS1220-03	12 [304]	350 [106]	20 [508]	150 [68]	29.6 [752]
PS1220-05	12 [304]	500 [152]	20 [508]	150 [68]	32.6 [828]

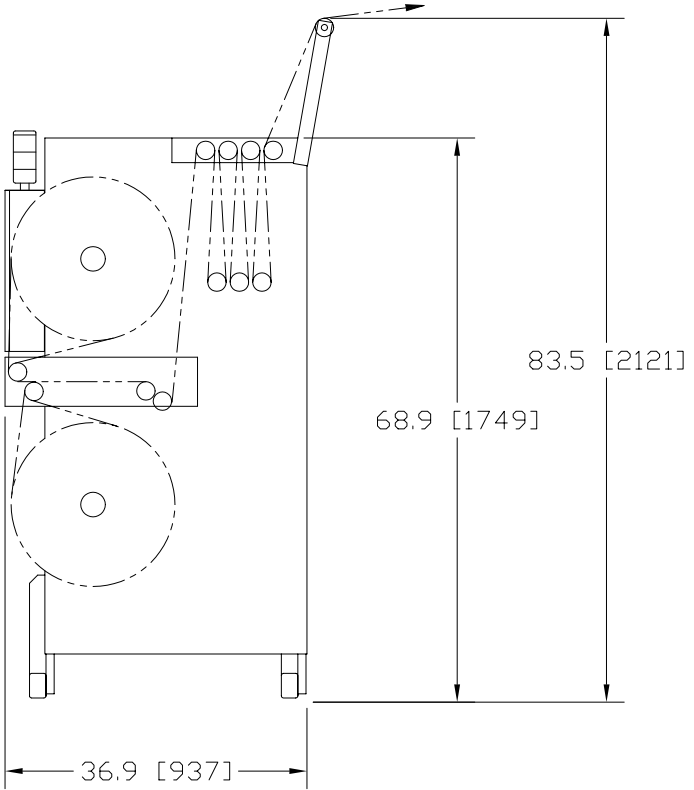
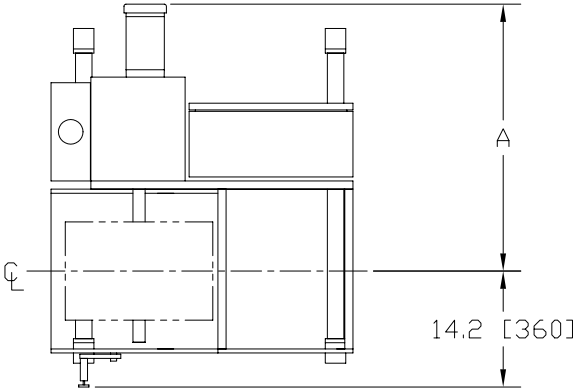

RIGHT HAND UNIT SHOWN

EST. SHIPPING WEIGHT: 1600 LBS  
[725 KG]  
EST. SHIPPING DIM: 60 X 60 X 90 IN  
[1524 X 1524 X 2286 MM]

PROPOSAL DRAWING: DIMENSIONS AND SPECIFICATIONS SUBJECT TO CHANGE WITHOUT NOTICE

**EKTIE**  
Keene Technology, Inc.  
14357 Commercial Pkwy.  
South Beloit, IL 61080  
(815)624-8989

TITLE:  
PS WINDOW FILM SPLICERS

DRAWN BY:  
CJP  
DATE:  
9/4/12  
DWG. NUMBER:  
PR827  
PAGE:  
1 OF 1

REVISIONS		
REV.	DESCRIPTION	DATE